

ALPHATRON

Alphatron Marine BV



Visit address:
Schaardijk 23
3063 NH ROTTERDAM

Post address:
Postbus 21003
3001 AA Rotterdam

T: +3110- 453 4000
F: +3110- 452 9214



THE HUMAN TOUCH IN TECHNOLOGY

The BNWAS system is made out of 3 parts or also called 3 alarm stages:

The 1st alarm stage:

This is a indication light and buzzer inside the main unit. This main unit(1) is on the bridge and warns the person on watch he should reset the alarm. The alarm can be reset on the main unit or on the remote reset button (2) or with a motion sensor. If the person on watch does not reset the alarm within 30 seconds the second stage alarm will sound.

The 2nd stage alarm will be heard in the cabin of the officer on duty. This is done via the officers selector switch(3), which can connect 6 differnt officers cabin units (4). Now the officer has 3 minutes to reset the alarm panel on the bridge. If the officer does not reset within 3 munites the 3rd stage alarm will sound all over the vessel (5) .

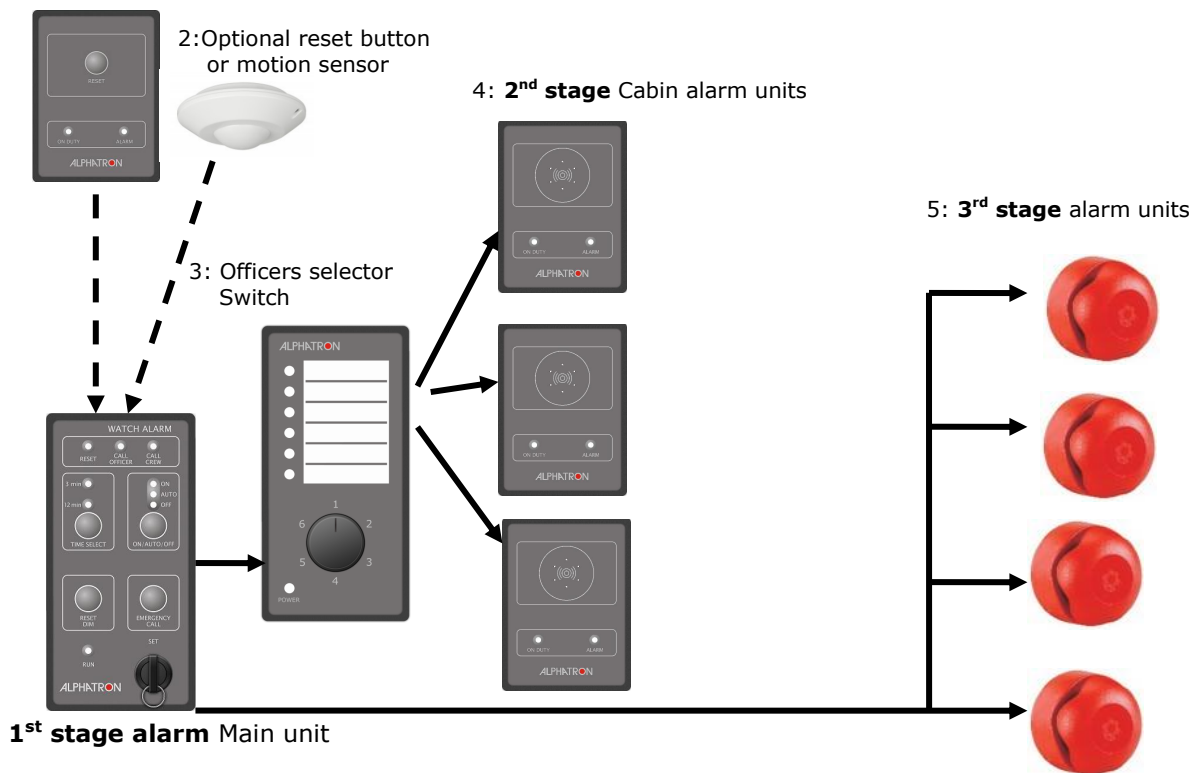

The main unit is connected to 24V DC. If the power fails a conact will be made. This contact is connected to an external alarm system. This second system will indicated faillure and alert crew. **Units 2,3 and 4 are optional (not mandatory) for non passenger vessels.**



Main unit (including reset button)

**Officer selector switch
(optional)**

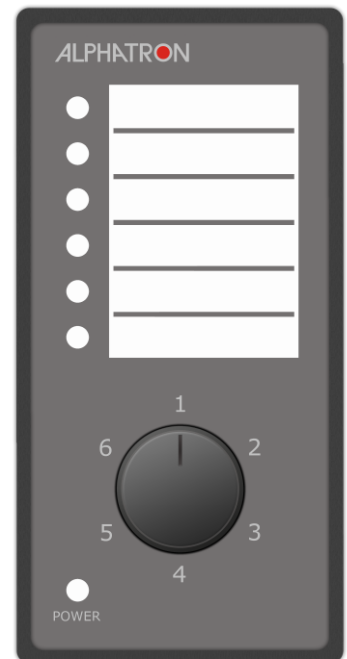

**Remote reset unit
(optional)**

**Officers cabin unit
(optional)**



More optional items:

Outdoor reset unit IP66.



Motion sensor 24V version (NON approved by LR and BV)

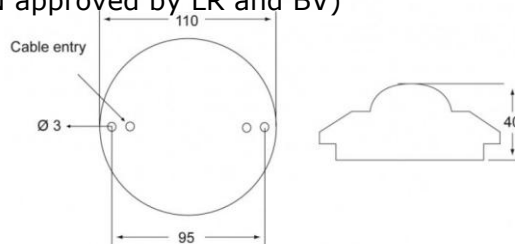

Mounting Heights (m)	2.4M	3.0m	3.6m	4.2m
Coverage (Diameter)	6.0m	7.5m	9.0m	10.5m